

2.5 AMP CAPACITY • 3/32" SQUARE

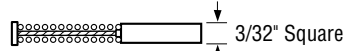

BRUSH ASSEMBLY • P/N 1072-1

*Material: FAG 180 (80% Ag - 20% C)

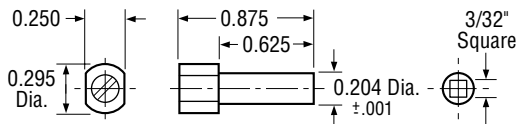

HOLDER ASSEMBLY • P/N 1070004

Material: Brass, tin plated (*brass cap included*)

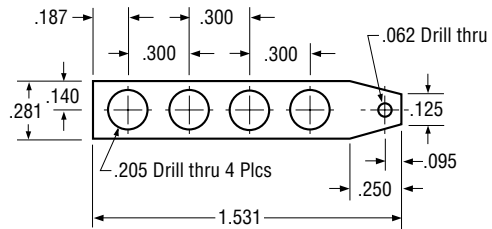

BUSS ASSEMBLY • P/N 1070011-7

Material: .020 thick BeCu, tin plated

4 AMP CAPACITY • 1/8" SQUARE

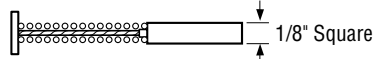

BRUSH ASSEMBLY • P/N 1072-2

*Material: FAG 180 (80% Ag - 20% C)

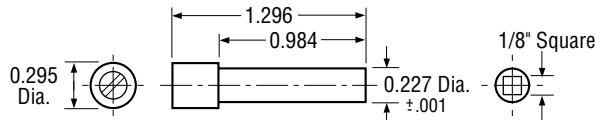

HOLDER ASSEMBLY • P/N 1051032

Material: Brass, tin plated (*brass cap included*)

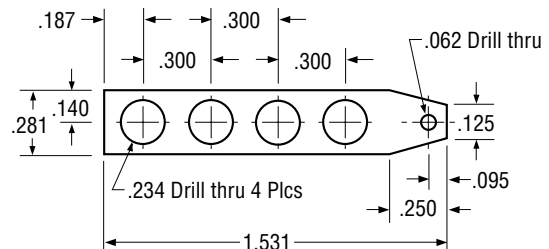

BUSS ASSEMBLY • P/N 1070011-9

Material: .020 thick BeCu, tin plated

10 AMP CAPACITY • 3/16" X 1/4" RECTANGULAR

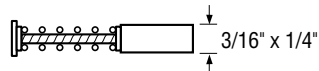

BRUSH ASSEMBLY • P/N 1913-1

*Material: FAG 180 (80% Ag - 20% C)

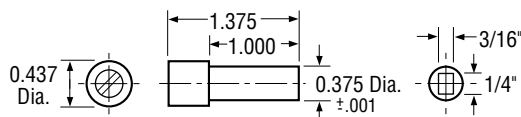

HOLDER ASSEMBLY • P/N 1913002

Material: Brass, tin plated
(*brass cap included*)

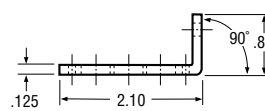

P/N 1913003-9

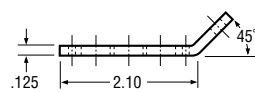

P/N 1913003-11

ANGLE BUSS ASSEMBLY
Material: .125 thick Copper, tin plated

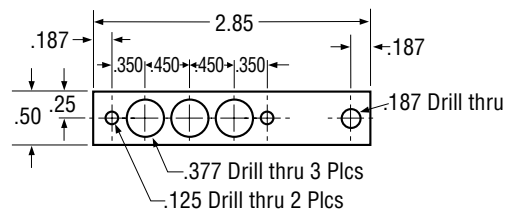

FLAT BUSS ASSEMBLY • P/N 1913003-7
Material: .125 thick Copper, tin plated

For further information on part number coding and optional brush contact materials see pages 14 and 15.

25 AMP CAPACITY • 1/4" X 1/2" RECTANGULAR

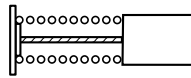

BRUSH ASSEMBLY • P/N 1092003
*Material: FAG 180 (80% Ag - 20% C)

TYPICAL ASSY.
50 Amp Std.
2 Brushes per Ckt.

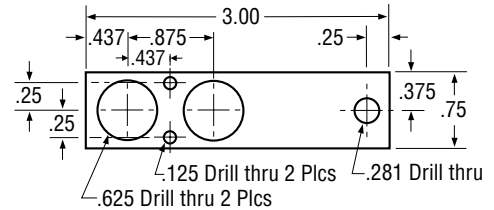
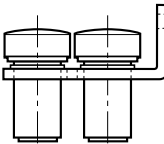

FLAT BUSS ASSEMBLY • P/N 1092007-7
Material: .125 thick Copper, tin plated

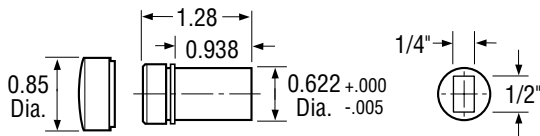

HOLDER ASSEMBLY • P/N 1092006
Material: Brass, tin plated
(plastic cap included)

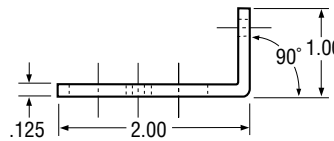

P/N 1092007-9

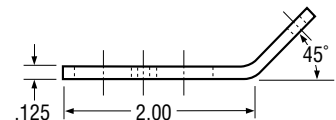

P/N 1092007-11

ANGLE BUSS ASSEMBLY
Material: .125 thick Copper, tin plated

50 AMP CAPACITY • TWO EACH 1/4" X 1/2" RECTANGULAR

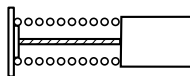

BRUSH ASSEMBLY • P/N 1991-1
*Material: FAG 180 (80% Ag - 20% C)
Two each per holder

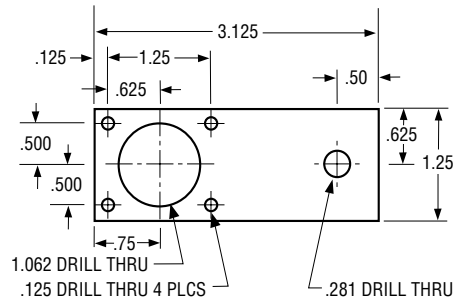

FLAT BUSS ASSEMBLY • P/N 1092014-7
Material: .125 thick Copper, tin plated

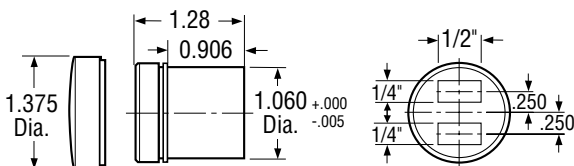

HOLDER ASSEMBLY • P/N 1092012
Material: Brass, tin plated (plastic cap included)

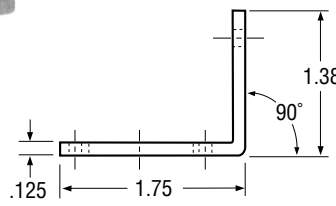

P/N 1092014-9

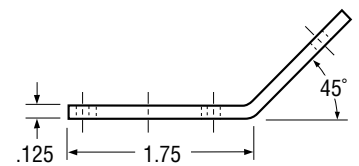

P/N 1092014-11

ANGLE BUSS ASSEMBLY
Material: .125 thick Copper, tin plated

For further information on part number coding and optional brush contact materials see pages 14 and 15.